

Set curb stakes & hubs for Grades  
 Both sides 23<sup>rd</sup> St from  
 Lincoln to Hall, and 33.5 ft  
 Each side of center of 23<sup>rd</sup> St,  
 from Sta 77+25.7 to Sta

84+19.7. <sup>From Sta 84+19.7 West to</sup>  
<sup>Sta 77+50 stakes and hubs</sup>  
<sup>should be set 0.5 farther West</sup>

A.M. Sept 19<sup>th</sup> 90

Set Cross Walk Stakes  
 North Side 25<sup>th</sup> St and across  
 Washington Ave, So Side 25<sup>th</sup> St and  
 across Washington Ave, and West  
 Side of Washington Ave and a-  
 cross 25<sup>th</sup> St. See sketch below.

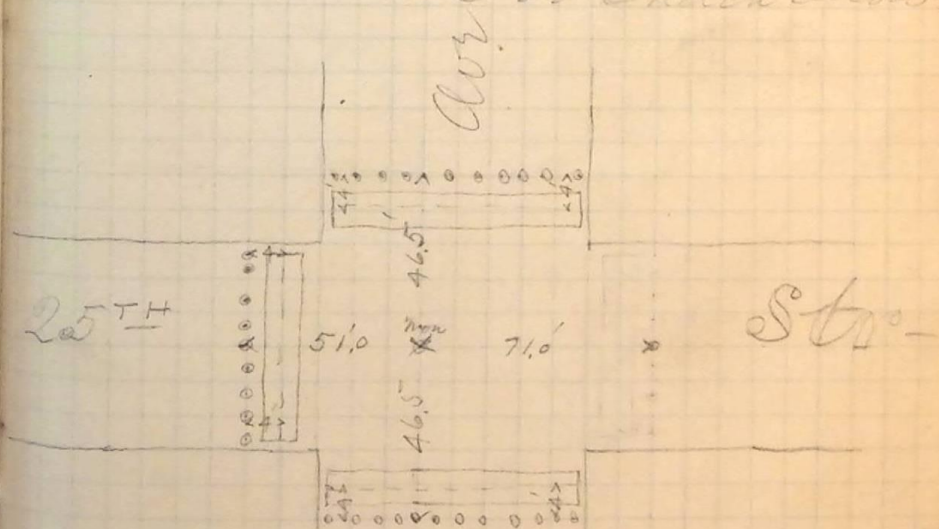

A.M.

Washington

Sept 19-90